

Series 200

Assembly instructions

Traditional assembly with Series 200 mounting plates

Place the hinge onto the mounting plate. Push the hinge up to the pre-determined stop under the hinge arm.

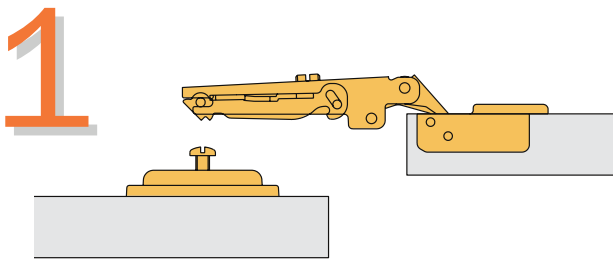

Tighten the fixing screw.

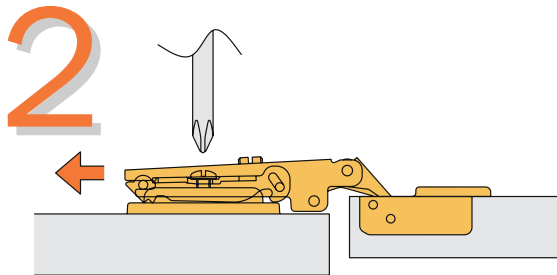

An «L» value of 0,7 mm between door and cabinet side is achieved on final assembly.

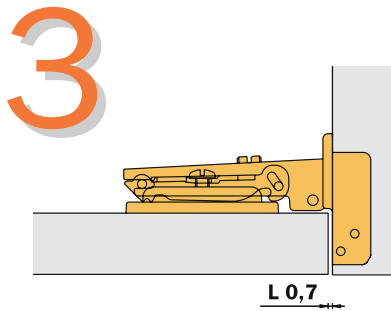

«Key hole» safety feature.

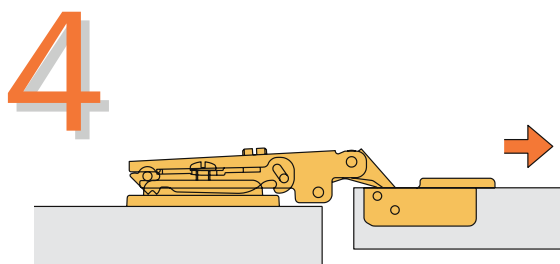

Assembly with DOMI® snap-on mounting plates

Locate the lugs on the mounting plate into the recesses beneath the arm.

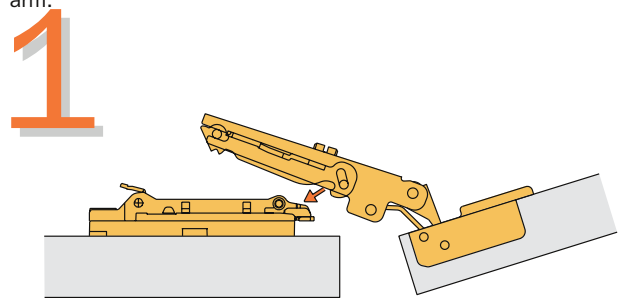

Gently rotate the door in the direction shown.

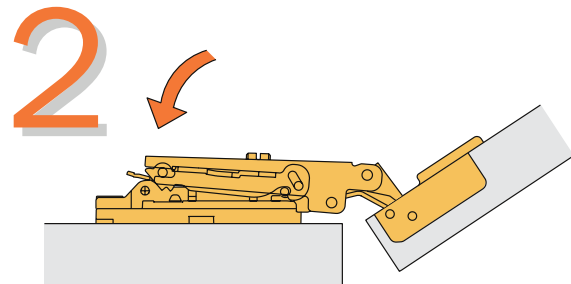

Then press lightly on the end of the arm to secure the catch.

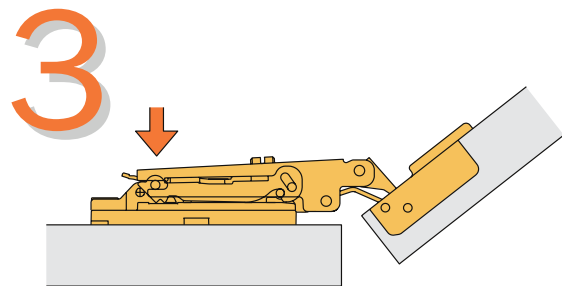

To remove the hinge from the mounting plate, press gently in the places shown by the arrows.

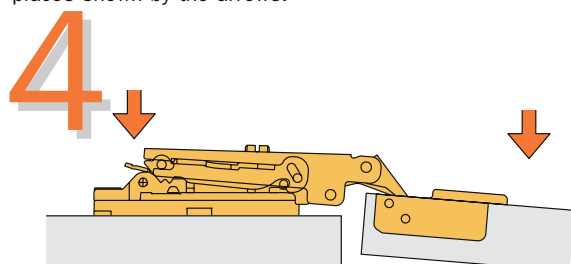

Depth adjustment

Traditional depth adjustment

The hinge fixing screw is slackeden and an oval slot on the arm of the hinge enables the door to be adjusted frontally by + 2,8 mm. Finally the fixing screw must be retightened.

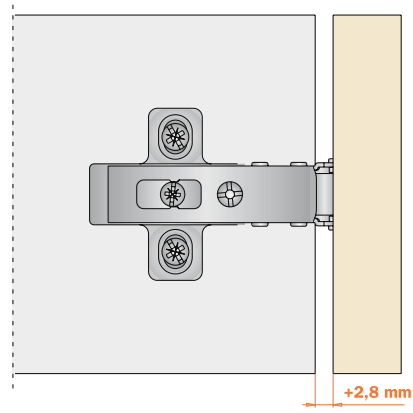
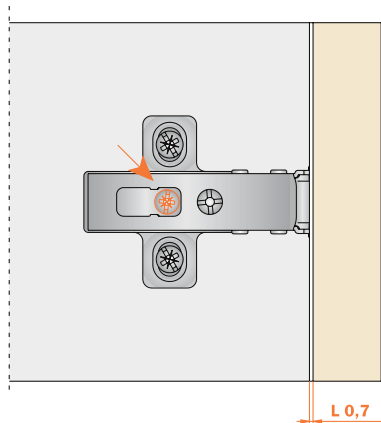
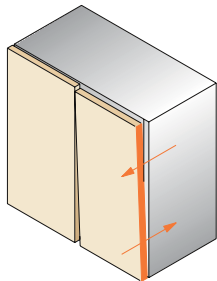

Depth adjustment with Domi® snap-on mounting plates - Models BAPXR and BARXR -

Depth adjustment is made without loosening any screws. The door can be moved frontally from -0,5 mm to +2,8 mm simply by rotating the cam adjuster in this range of mounting plates.

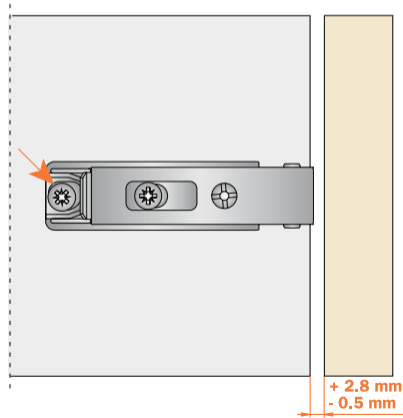
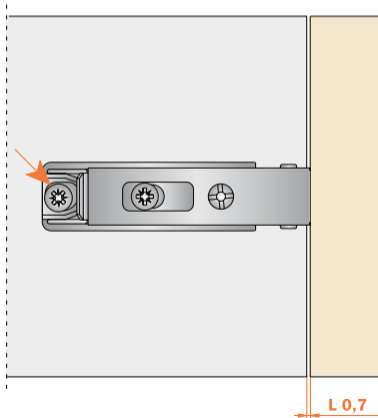
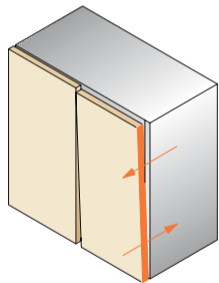

Height adjustment

Height adjustment with Series 200 and Domi® snap-on mounting plates - Model BAV

By loosening the two fixing screws it is possible to adjust the door vertically by ± 2 mm. The oval holes allow the mounting plate to slide freely in both directions. Finally, the screws must be retightened.

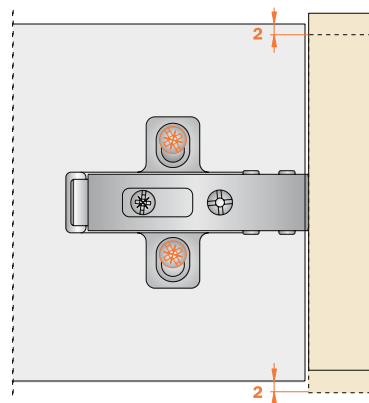
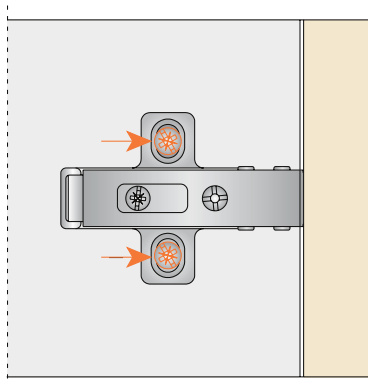
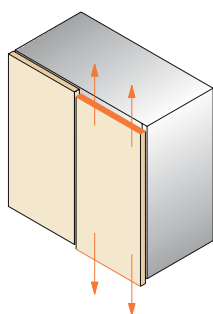

Height adjustment with Series 200 hinges - Models B2RXE and B2PXE -

Height adjustment is made without loosening any screws. The door can be moved vertically by ± 2 mm simply by rotating the cam adjuster in this range of mounting plates.

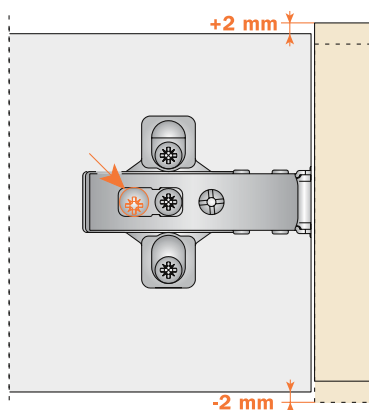
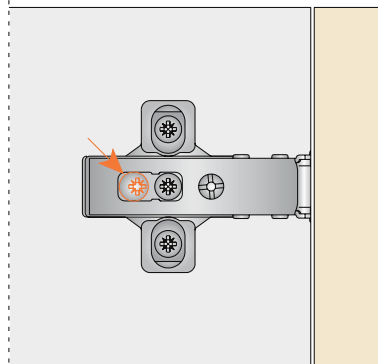
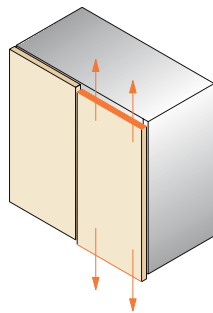

Height adjustment with Domi® snap-on mounting plates - Models BAPXR and BARXR -

Height adjustment is made without loosening any screws. The door can be moved vertically by ± 2 mm simply by rotating the cam adjuster in this range of mounting plates.

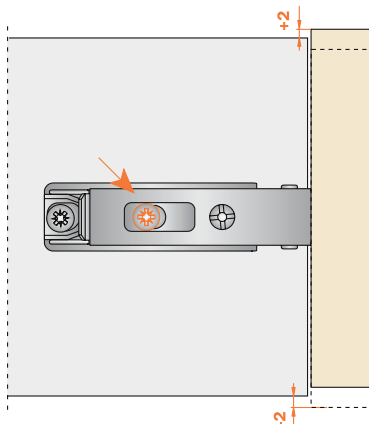
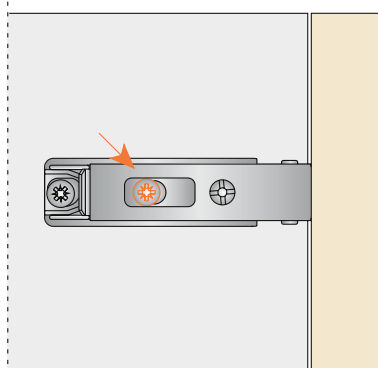
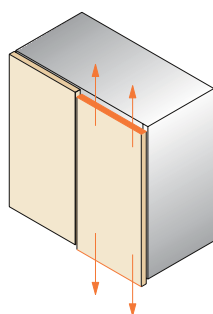

Sideways adjustment

Sideways adjustment of the door with Series 200, 100, Logica, B, 300, F and 400 hinges

A specially developed technical solution allows the sideways adjustment of the door while maintaining the gap behind the door ("L" value of 0.7 mm). The adjustment screw operates in conjunction with the inner leaf of the hinge arm. The door moves in only one direction - parallel to the carcase and without a gap developing between the door and the carcase. No further adjustments are necessary.

